

- 1. FONTERRA
- 2. DAIRY EXPORTER
- 3. TAGIT
- 4.
- 5. IPC
- 6. TIRAU EARTH MOVERS
- 7. OPUS
- 8. PRESCO
- 9. PRECISION FARMING
- 10. WILLIAMS ENGINEERING
- 11. NEVADA
- 12. NEVADA
- 13. GEO HUTCHINSON & CO LTD
- 14. REID & HARRISON
- 15. DAIRY NZ
- 16. COUNCILS
- 17. EBOP
- 18. PRECISE DAIRY
- 19. PUMP & VALVE
- 20. AZTECH
- 21. AZTECH
- 22. ARCHWAY GROUP
- 23. TASMAN TANKS
- 24. VIKING CONTAINMENT
- 25. HILL LABORATORIES
- 26. RED PATH PACIFIC
- 27. FORWARD FARMING
- 28. RAINER IRRIGATION
- 29. EIDNZ
- 30. WAIKATO REGIONAL COUNCIL
- 31. HITECH
- 32. QBICK
- 33. SMART SHELTERS
- 34. PUMPN

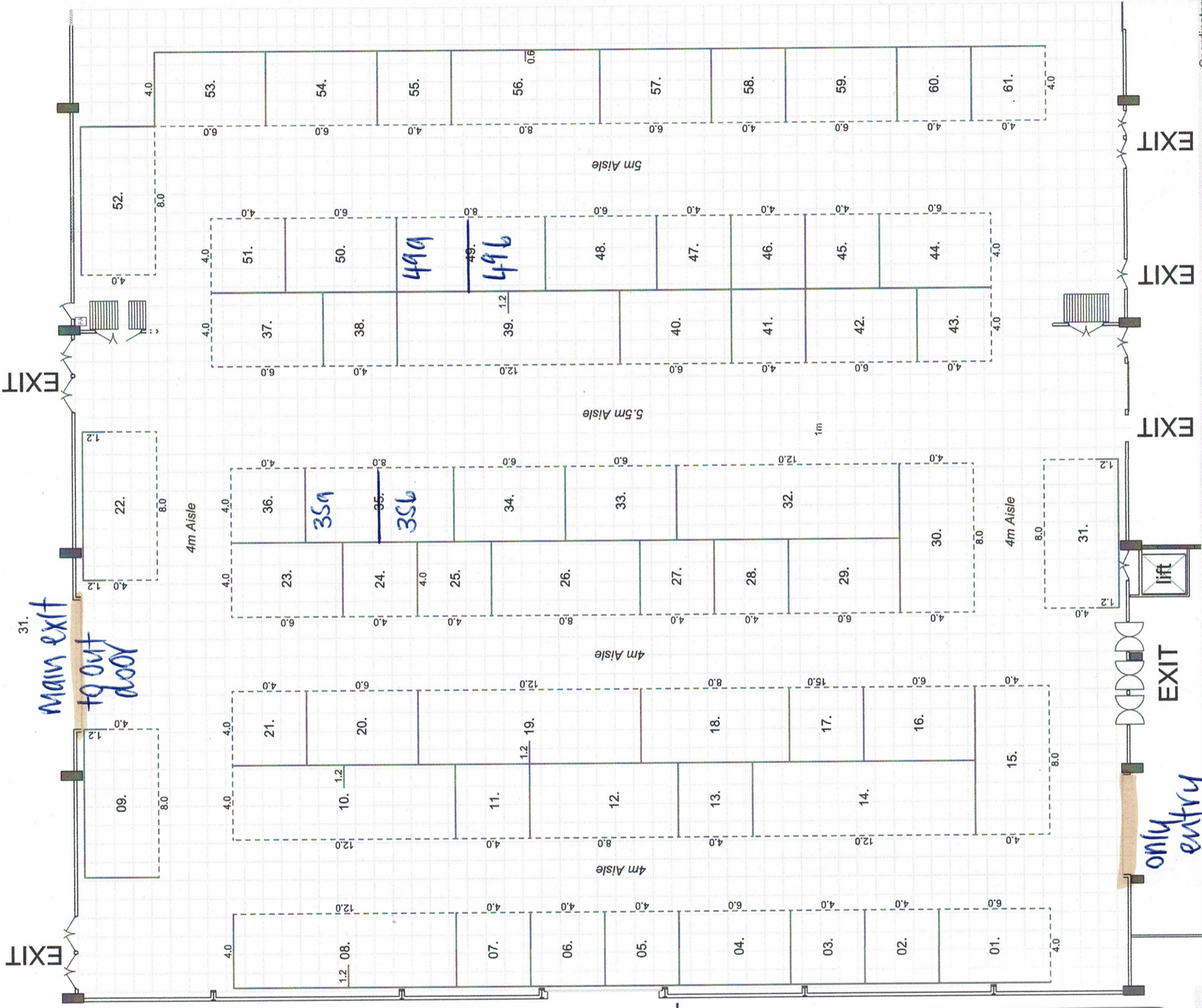

- 35a.
- 35b
- 36. REGEN LIMITED
- 37. PLUCKS ENGINEERING
- 38. ASPECT ENVIRONMENTAL
- 39. TANKS & SILOS
- 40. FORSI
- 41. I.S DAM LINING
- 42.
- 43. HERD HOMES
- 44. CLEAN GREEN
- 45. RX PLASTICS
- 46. COSIO INDUSTRIES
- 47. OSPRI
- 48.
- 49a.
- 49b.
- 50.
- 51. NUMAT
- 52. HARVEST ELECTRONICS
- 53. COFFEE CART
- 54.
- 55. ENVIROLINE
- 56. AGFIRST
- 57.
- 58. PRECAST TANKS
- 59.
- 60. TLS
- 61. PPP INDUSTRIES

Coordinator: Steph Hill  
 Event Date: 27.11.18  
 Designer: NM 27.06.18  
 Scale: A3  
 Drawing: Effluent 2018 V05

**Effluent 2018**  
 Venue: Mystery Creek, Hamilton